

AIRSTAGE

FUJITSU

AIR CONDITIONING



FUJITSU GENERAL AIR CONDITIONING (UK) LIMITED

Air To Water Monobloc

The **NEW** Fujitsu Monobloc

All -in-model, no need for refrigerant piping
Installation only requires hydraulic connection work.

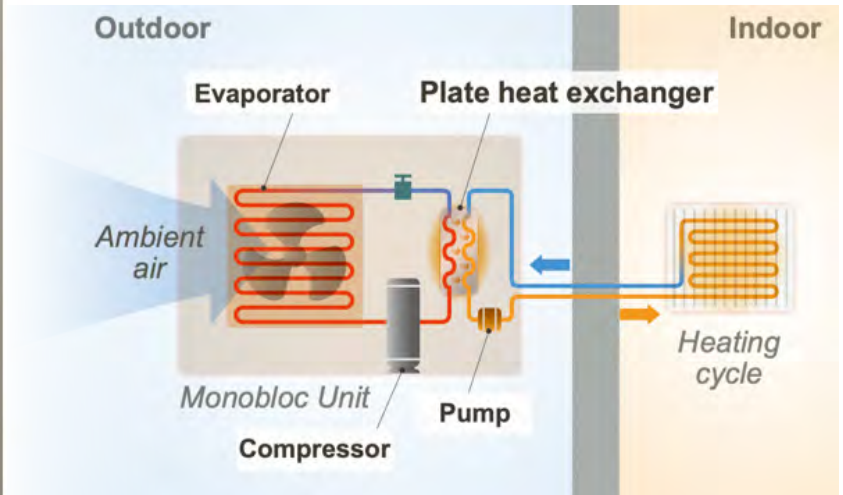

Optional Control Box Locations

Control Box Wall Mounted

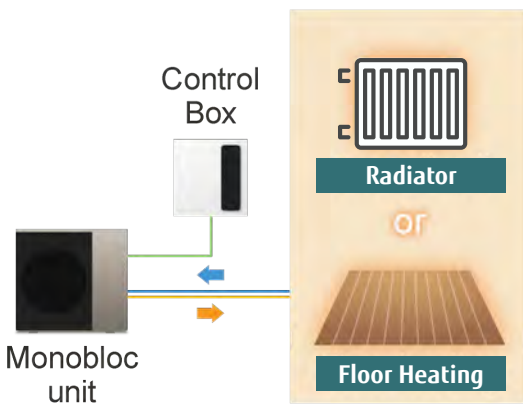

Control Box Mounted on Domestic Hot Water Tank

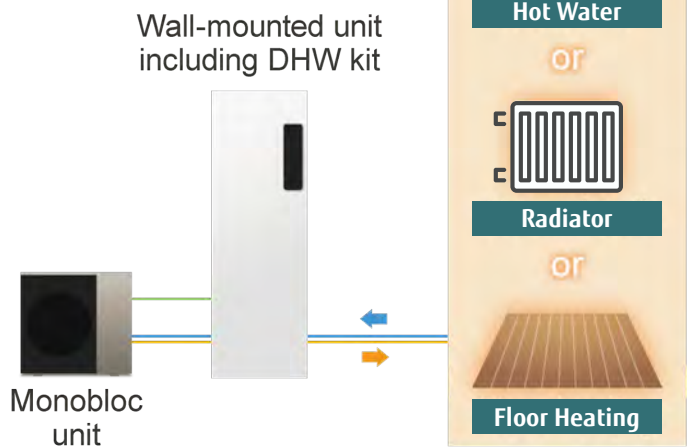

High Energy Saving

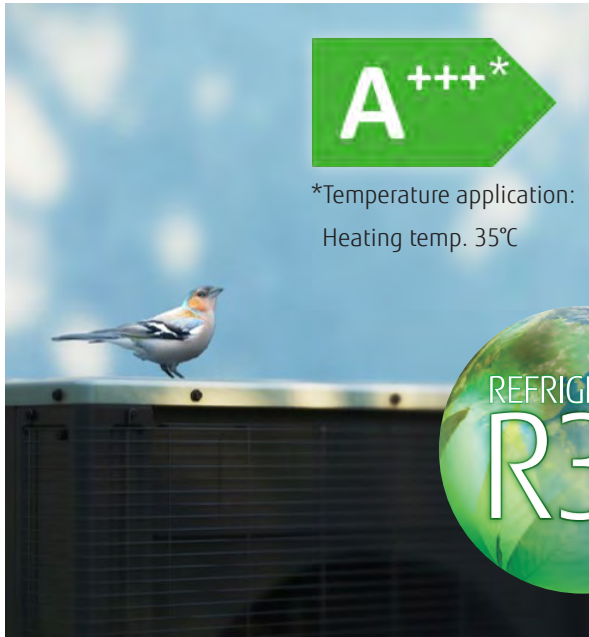

Plate heat exchanger with high heat exchange performance improves energy-related product performance, achieving high energy efficiency.

- High Efficiency Plate Heat Exchanger
- DC Twin Rotary Compressor
- DC Fan Motor
- DC Inverter

Adopting an environmentally friendly R32 refrigerant

Seasonal Space Heating Energy Efficiency



Conditions:
Outdoor Temp: 7°C
Heating Temp: 35°C

High Water Flow Temperature



Hot water is to be supplied at temperatures of up to 60°C, even when the outside Temperature is -5°C

This function allows for the safe use of the Air To Water in cold regions

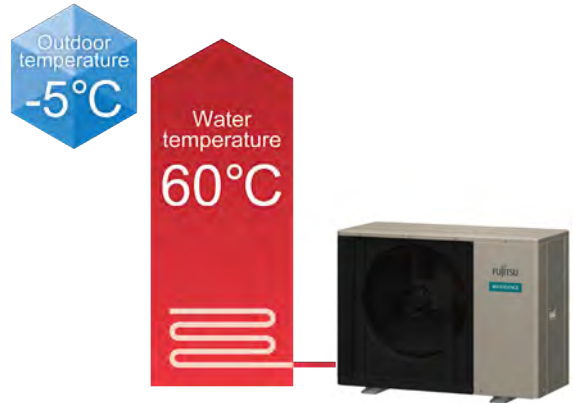

Quiet Operation

In the outdoor unit, a larger fan and a sound-insulating structure in the compressor part reduce the maximum operating noise. Low noise mode can be set from the user interface on the control box.

	TENTATIVE		
Model	WPEG050KPF	WPEG080KPF	WPEG100KPF
Capacity	5kW	8kW	10kW
Sound Pressure Level*	44 dB(A)		46 dB(A)

* Front: 1m / Height: 1.5m



Aesthetic and Compact Design

The system blends in with the landscape.

Harmonizing with a variety of installation locations.

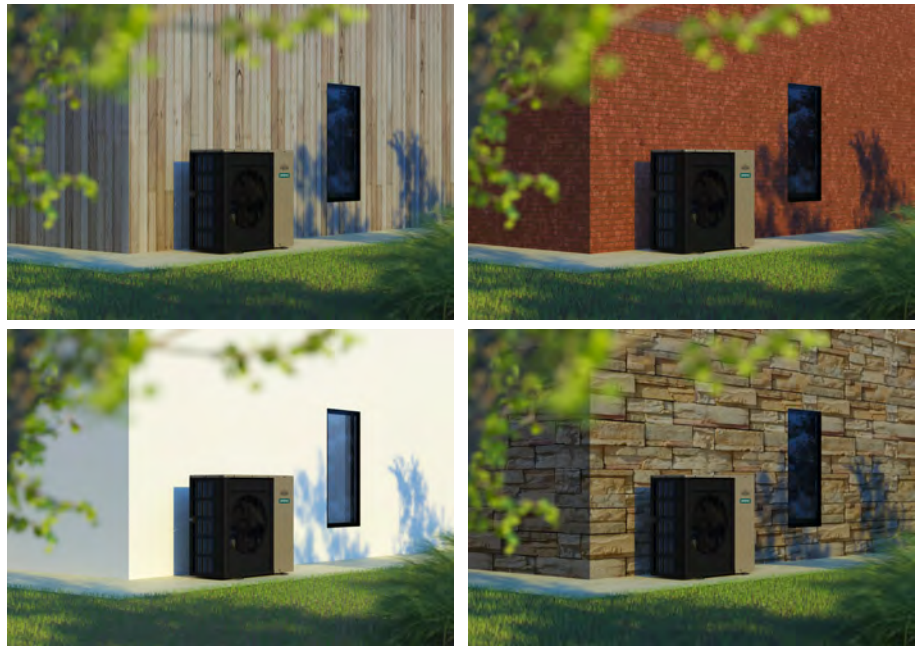

5kW Class

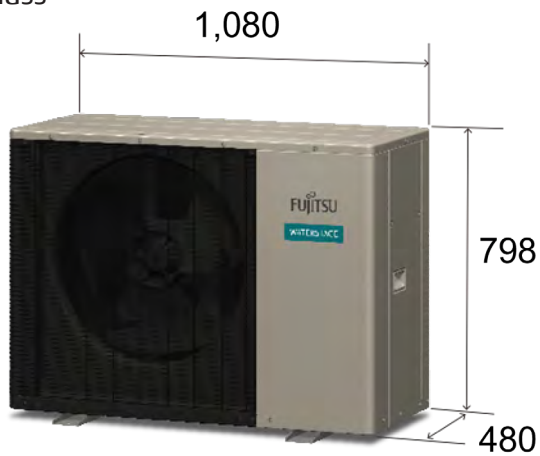

8 & 10kW Class

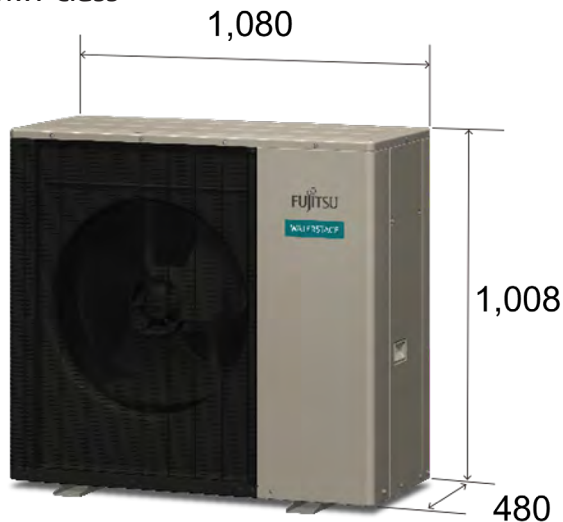

Easy Installation & Maintenance

All service and maintenance can be done by removing the side panel only

In addition, access from one direction simplifies the installation



Front and Side Access Required



Side Access Only

Service Monitoring Tool

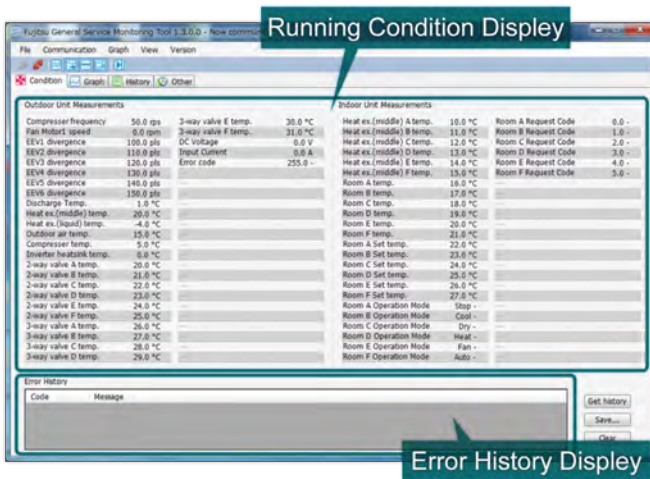

Operational Status

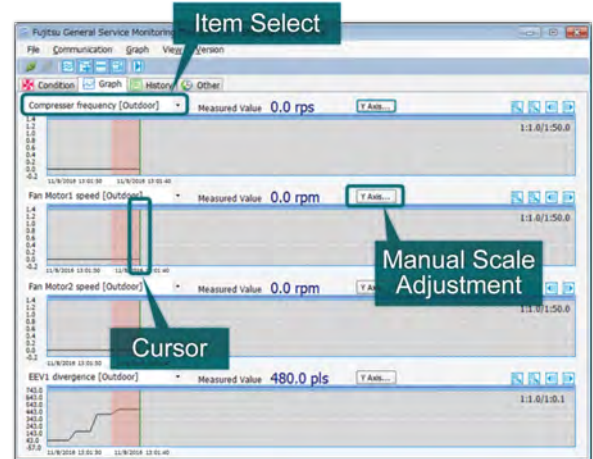

Graph showing operational status

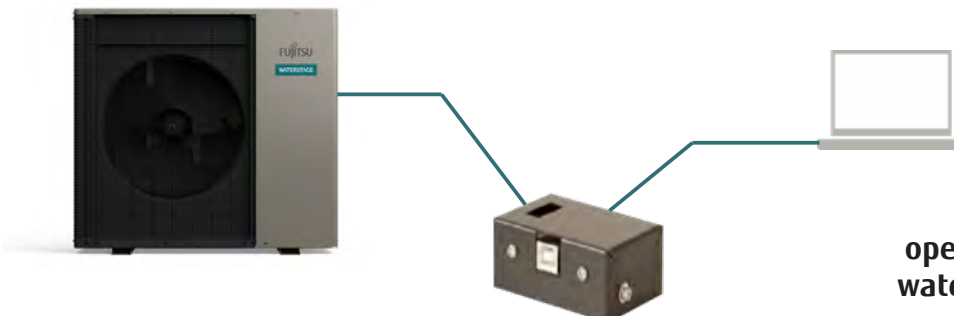

The service monitoring tool (UTY-ASSX) provides an operational status check for the water temperature, flow sensors and other data from your PC.

Specifications

				TENTATIVE			
				WPEG050KPF	WPEG080KPF	WPEG100KPF	
Power source				1Phase / 230V / 50Hz			
Copressor control				Inverter			
Refrigerant			Type	R32			
			Charge	kg	0.88	1.47	
Heating	Rated performance	A7W35	Capacity	kW	5.00	8.00	10.0
			Input power	kW	0.97	1.54	2.05
			COP	kW/kW	5.15	5.19	4.88
		A7W55	Capacity	kW	5.00	8.00	10.0
			Input power	kW	1.64	2.62	3.36
			COP	kW/kW	3.04	3.05	2.98
	Low Outside Performance	A-7W35	Capacity	kW	5.10	8.18	9.53
			Input power	kW	1.63	2.56	3.05
			COP	kW/kW	3.13	3.19	3.12
		A-7W55	Capacity	kW	4.80	7.50	8.50
			Input power	kW	2.25	3.50	3.97
			COP	kW/kW	2.13	2.14	2.14
	Temperature application range			°C	17 to 60		
	Outside temperature Operating range			°C	-20 to 35		
	Sound Pressure Level		A7W55	dB(A)	44		46
Sound Power Level		A7W55	dB(A)		60	62	
		A7W55	dB(A)	52	56	57	
Cooling	Rated performance	A35W7	Capacity	kW	4.50	6.80	8.50
			Input power	kW	1.43	2.10	2.80
			EER	kW/kW	3.15	3.24	3.04
		A35W18	Capacity	kW	5.45	8.00	10.00
			Input power	kW	1.25	1.73	2.46
			EER		4.35	4.63	4.06
	Exit temperature application range			°C	7 to 25		
Operating range			°C	8 to 46			
Temperature application range			°C	60			
Outside temperature Operating range			°C	-20 to 35			
ErP	P rated (Fiche)	Standard temperature	Low temp.	kW	5.8(6)	9.0(9)	10.2(10)
			Medium temp.		5.5(6)	8.7(9)	9.9(10)
	Seasonal space heating energy efficiency(ns)	Standard temperature	Low temp.	%	200	205	206
			Medium temp.		143	144	146
	Energy efficiency class	Standard temperature	Low temp.	-	A+++		
			Medium temp.		A++		
Dimensions (H×W×D)			Net	mm	798×1080×480	1008×1080×480	
Weight			Net	kg	85	109	
Current				A	16	25	

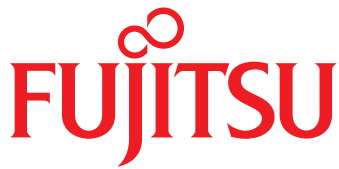

AIR CONDITIONING

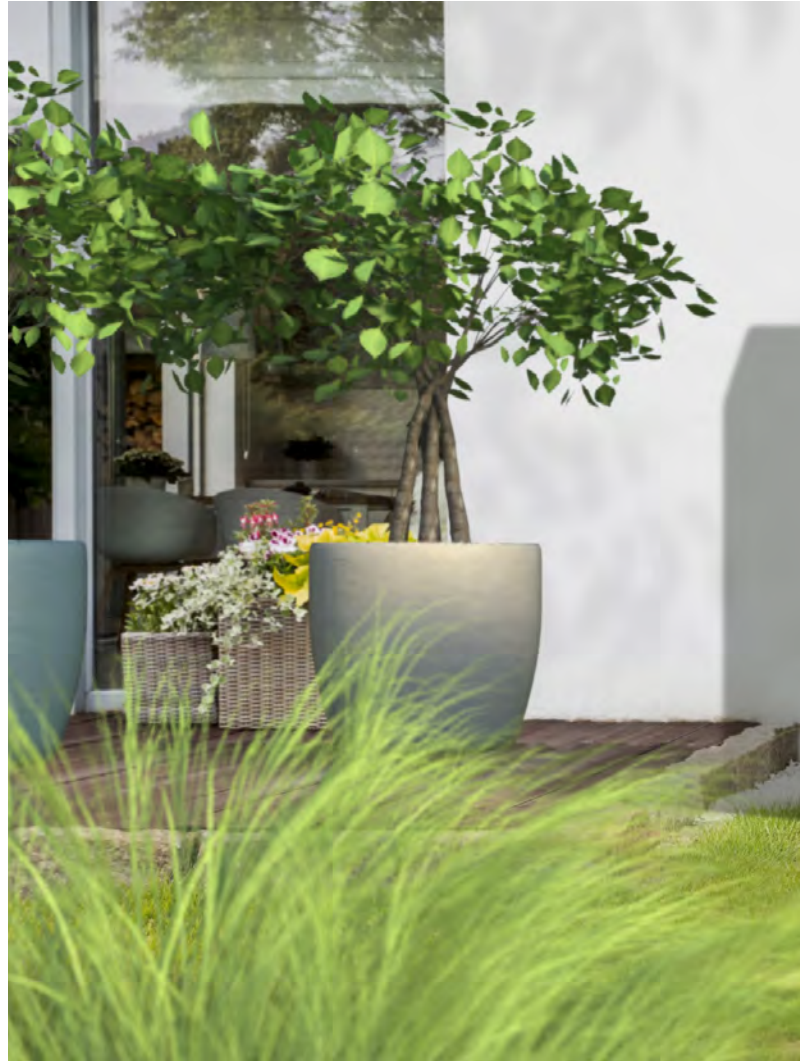

www.fujitsu-general.com/uk



www.webstore.uk.fujitsu-general.com



FUJITSU GENERAL AIR CONDITIONING (UK) LIMITED
Unit 150, Centennial Park, Centennial Avenue, Elstree, Borehamwood, Herts, WD6 3SG
sales@fgac.fujitsu-general.com
Tel: +44 (0) 208 731 3450 Fax: +44 (0) 208 731 3451